



The Instrument Case Series Provides a Variety of Options

- Constructed of seamless deep drawn aluminum shells.
- Three closure options.
- Variations of internal panel mounting, give added versatility in the packaging of electronic, electro-mechanical, or instrumentation equipment.
- Standard sizes listed for each Series.
- Custom sizes—design a case from standard Deep Drawn sizes.

Features and Specifications

- Material: Aluminum Alloy
- Latches: Zamak #7—nickel plated
- Hinges: Riveted-nickel plated steel, Separable on all styles
- Handle: Black molded plastic with nickel plated hardware
- Feet: 5000/7000, 800 and 600 Series: Integral dimpled; 400 Series: Four, black rubber
- Gasket: Black extruded synthetic rubber—5000/7000, 800
- Panels: Aluminum with chemical film finish
Material Thickness—0.090"
- Tolerances: ± 0.06"

Off-Shelf Availability WITH No Tooling Charge

- All listed sizes can be utilized without a tooling charge.

Standard Finish—Textured Powder Coat Paint

for INTERIOR & EXTERIOR, less hardware
MB Medium Blue Powder Coat, Color No. 25190

Choose Standard Powdercoat Finish, Custom Colors Available—Fed-Std-595, RAL, Pantone Matching System or Special

- 00 Olive Drab Powder Coat, Color No. 24097
 - BK Black Powder Coat, Color No. 27038
 - DB Dark Blue Powder Coat, Color No. 25045
 - DS Desert Sand Powder Coat, Color No. 20372
 - FG Forest Green Powder Coat, Color No. 24079
 - GR Gray Powder Coat, Color No. 26307
 - LG Light Gray Powder Coat, Color No. 26622
 - MB Medium Blue Powder Coat, Color No. 25190
 - NG NATO Green Powder Coat, Color No. RAL6014
 - OR Orange Powder Coat, Color No. 21400
 - RD Red Powder Coat, Color No. 21105
 - WH White Powder Coat, Color No. 27925
 - YW Yellow Powder Coat, Color No. 23538
- FED-STD-595 numbers for reference.



5000 / 7000 Series

Most Economical
5000: non-separable hinges.
7000: separable hinges.



800 Series

Most Versatile
Fully O-ring gasketed closure of extruded aluminum, spot-welded to interior case shell. Permits installation of optional panel support brackets, and full size primed panel.



600 Series

Spot-welded, pre-drilled panel flange, Includes a chemical film finished panel with basic case.



400 Series

Includes Instrument Panel

Case dimensions are always shown in the following order:

- WIDTH—the narrowest measurement, looking down on the case.
- LENGTH—the longest measurement, looking down on the case.
- HEIGHT—measured from base to top. The "upper" shell is designated H¹. The "lower" shell is designated H².

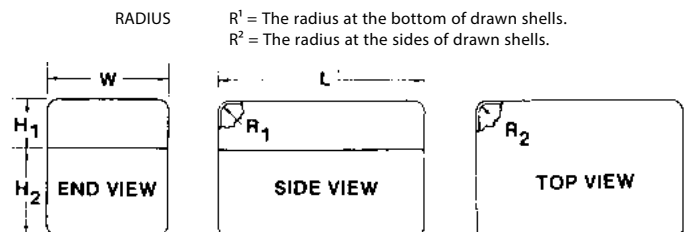



Off-Shelf Availability WITH No Tooling Charge

These distinctively designed deep drawn aluminum instrument cases give small instruments a sales-appealing custom appearance at off-the-shelf prices.

- Seamless deep drawn body provides protection even under rugged conditions.
- Most economical of the Instrument cases.
- Available in 11 off-the-shelf sizes.
- 5000 Series have non-separable hinges.
- 7000 Series include separable hinges.
- All cases feature fully gasketed, bonded closures which fit over the edge of the lower shell.

Features and Specifications

- Material: Aluminum Alloy
- Latches: Zamak #7—nickel plated
- Hinges: Riveted-nickel plated steel, Separable on all styles
- Handle: Black molded plastic with nickel plated hardware
- Feet: Integral dimpled
- Gasket: Black extruded synthetic rubber
- Panels: Aluminum with chemical film finish
Material Thickness—0.090"
- Tolerances: ± 0.06"

Standard Finish—Textured Powder Coat Paint Finish

for INTERIOR & EXTERIOR, less hardware
MB Medium Blue Powder Coat, Color No. 25190

Custom Colors Are Available—Fed-Std-595, RAL, Pantone Matching System or Special

- 00 Olive Drab Powder Coat, Color No. 24097
 - BK Black Powder Coat, Color No. 27038
 - DB Dark Blue Powder Coat, Color No. 25045
 - DS Desert Sand Powder Coat, Color No. 20372
 - FG Forest Green Powder Coat, Color No. 24079
 - GR Gray Powder Coat, Color No. 26307
 - LG Light Gray Powder Coat, Color No. 26622
 - MB Medium Blue Powder Coat, Color No. 25190
 - NG NATO Green Powder Coat, Color No. RAL6014
 - OR Orange Powder Coat, Color No. 21400
 - RD Red Powder Coat, Color No. 21105
 - WH White Powder Coat, Color No. 27925
 - YW Yellow Powder Coat, Color No. 23538
- FED-STD-595 numbers for reference.

Customization

- Custom sizes—You may design a case from the standard sizes of deep drawn enclosures in the Deep Drawn Catalog.
- Hardware to spec

5000 SERIES Non-Separable Hinge	7000 SERIES Separable Hinge	EXTERIOR				INTERIOR		ALLOY	T	LATCHES		WEIGHT LBS
		W	L	H ¹	H ²	R ¹	R ²			FRONT	SIDE	
ZC5010	ZC7010	4.00	7.00	1.25	2.91	0.31	0.31	1100-0	0.06	2	—	1.30
ZC5020	ZC7020	4.00	8.75	1.25	2.91	0.19	0.25	1100-0	0.06	2	—	1.60
ZC5030	ZC7030	5.00	7.00	1.25	3.66	0.31	0.31	1100-0	0.06	2	—	1.70
ZC5040	ZC7040	5.50	8.00	1.25	3.66	0.25	0.25	1100-0	0.06	2	—	1.80
ZC5050	ZC7050	5.69	10.00	1.25	4.66	0.25	0.25	1100-0	0.06	2	—	2.30
ZC5060	ZC7060	6.00	9.00	1.25	4.66	0.31	0.31	1100-0	0.06	2	—	2.20
ZC5070	ZC7070	6.00	14.50	1.38	4.53	0.44	0.50	1100-0	0.06	2	—	2.90
ZC5080	ZC7080	7.00	11.00	1.50	5.41	0.50	0.31	6061-0	0.06	2	—	2.90
ZC5090	ZC7090	8.00	14.00	1.88	6.03	0.88	0.88	6061-0	0.06	2	—	3.80
ZC5100	ZC7100	9.00	9.00	1.50	6.41	0.50	0.50	6061-0	0.06	2	—	3.20
ZC5110	ZC7110	9.18	13.25	1.63	7.28	0.59	0.59	6061-0	0.06	2	1	4.60

Measurements shown in inches. T=thickness.

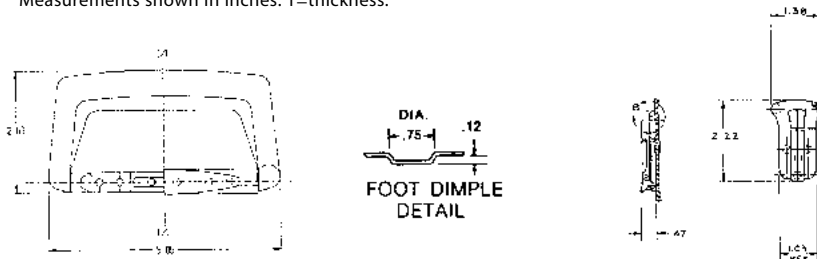



Off-Shelf Availability WITH No Tooling Charge

- Most versatile series of the Instrument cases.
- Fully gasketed closure of extruded aluminum, spot-welded to the interior case shell.
- Permits installation of optional panel support brackets.
- Permits full size primed panel (order separately).
- O-ring gasket provides additional environmental protection.

Features and Specifications

- Material: Aluminum Alloy
- Latches: Zamak #7—nickel plated
- Hinges: Riveted-nickel plated steel, Separable on all styles
- Handle: Black molded plastic with nickel plated hardware
- Feet: Four, black rubber
- Gasket: Black extruded synthetic rubber
- Panels: Aluminum with chemical film finish
Material Thickness—0.090"
- Tolerances: ± 0.06"

Standard Finish—Textured Powder Coat Paint Finish

for INTERIOR & EXTERIOR, less hardware
MB Medium Blue Powder Coat, Color No. 25190

Custom Colors Are Available—Fed-Std-595, RAL, Pantone Matching System or Special

- 00 Olive Drab Powder Coat, Color No. 24097
 - BK Black Powder Coat, Color No. 27038
 - DB Dark Blue Powder Coat, Color No. 25045
 - DS Desert Sand Powder Coat, Color No. 20372
 - FG Forest Green Powder Coat, Color No. 24079
 - GR Gray Powder Coat, Color No. 26307
 - LG Light Gray Powder Coat, Color No. 26622
 - MB Medium Blue Powder Coat, Color No. 25190
 - NG NATO Green Powder Coat, Color No. RAL6014
 - OR Orange Powder Coat, Color No. 21400
 - RD Red Powder Coat, Color No. 21105
 - WH White Powder Coat, Color No. 27925
 - YW Yellow Powder Coat, Color No. 23538
- FED-STD-595 numbers for reference.

Customization

- Custom sizes—You may design a case from the standard sizes of deep drawn enclosures in the Deep Drawn Catalog.
- Panels, Brackets, Hardware to spec

CASE ① NUMBER	W	L	H ¹	H ²	T	ALLOY	R ¹	R ²	FRONT	LATCHES		PANEL ② NUMBER	STANDARD MOUNTING BRACKETS	WT LBS
										SIDE	HINGES			
805	6.00	9.00	2.50	5.00	.06	1100-0	.31	.31	2	–	2	ZP9178-05	4	2.9
810	7.00	11.00	2.50	7.00	.06	6061-0	.50	.31	2	–	2	ZP9178-10	4	3.9
820	8.00	14.00	2.50	7.00	.06	6061-0	.88	.88	2	–	2	ZP9178-20	6	4.8
830	8.75	12.00	2.50	8.00	.06	6061-0	.50	.75	2	–	2	ZP9178-30	6	4.8
840	9.19	13.25	2.50	9.00	.06	6061-0	.59	.59	2	–	2	ZP9178-40	6	5.6
850	10.00	16.00	2.50	9.00	.09	6061-0	1.00	1.00	2	1	3	ZP9178-50	8	8.8

Note: W, L and H are exterior dimensions, R¹ and R², are interior dimensions. T= Thickness. Measurements shown in inches.

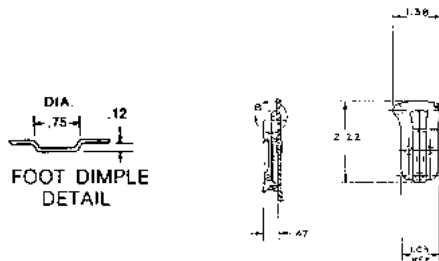
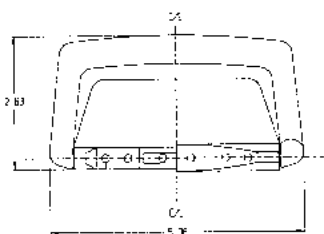



PANEL DIMENSIONS GUIDE

PANEL NUMBER	A	B	C	D	E	F	G	H	R	# OF HOLES
ZP9178-05	5.37	8.37	1.50	-	6.31	-	-	4.81	0.19	4
ZP9178-10	6.37	10.37	2.00	-	7.81	-	-	5.81	0.19	4
ZP9178-20	7.37	13.37	2.88	-	9.94	12.81	3.41	6.81	0.63	6
ZP9178-30	8.12	11.37	2.00	-	8.81	10.81	3.78	7.56	0.50	6
ZP9178-40	8.56	12.62	2.50	-	9.56	12.06	4.00	8.00	0.44	6
ZP9178-50	9.31	15.31	2.50	7.37	12.25	14.75	4.38	8.75	0.75	8

Measurements shown in inches.
 Material: 6061-T6 Aluminum Alloy. Thickness = 0.090"
 Finish: Epoxy primer per MIL-PRF-23377, Type I, CLASS C2.

ADJUSTABLE PANEL SUPPORT BRACKET

PART #ZSP9-014-3 Optional Accessory
 The adjustable panel support bracket shown is an accessory.
 If required, specify quantity needed for interface with
 equipment panel (See ordering information).
 Installation instructions shown at right.

HOLE PATTERN DIMENSIONS

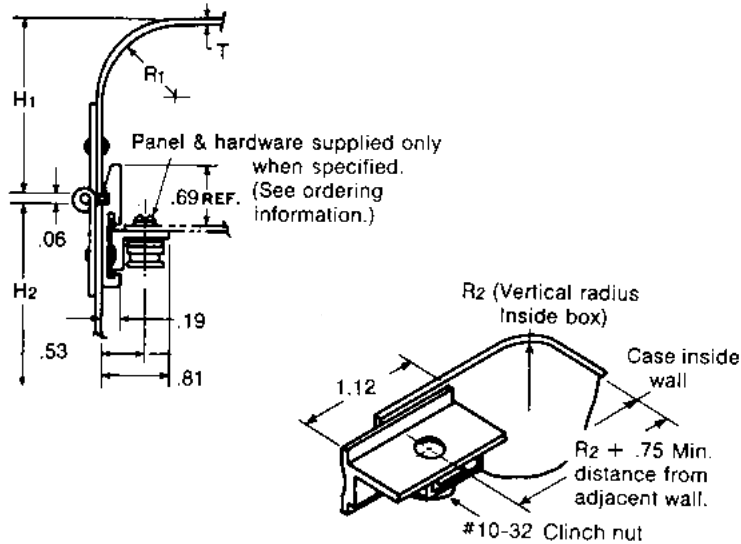
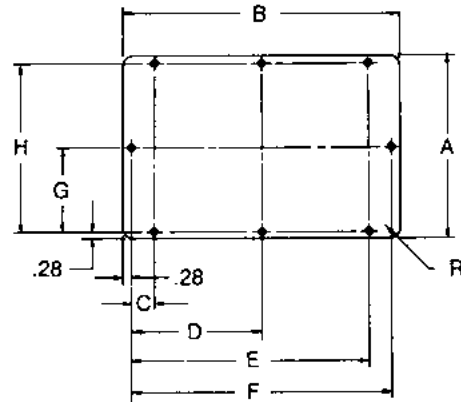

BRACKET INSTALLATION DIAGRAM

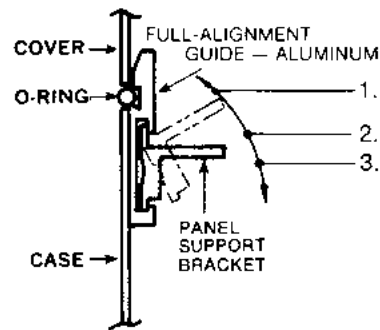

INSTRUCTIONS for PERMANENT INSTALLATION OF PANEL SUPPORT BRACKET

1. Apply room temperature cure epoxy to contact surface of support bracket and insert bracket into extrusion slot as shown.
2. Rotate downward, as shown, until support bracket is seated.
3. Slide bracket laterally as required to align bracket with panel hole location.
4. Allow epoxy to cure prior to further handling. (Note: Epoxy can be obtained locally at most hardware or industrial supply houses.)



Features and Specifications

- Material: Aluminum Alloy
- Latches: Zamak #7—nickel plated
- Hinges: Riveted-nickel plated steel, Separable on all styles
- Handle: Black molded plastic with nickel plated hardware
- Feet: Integral dimpled
- Gasket: Black extruded synthetic rubber
- Panels: Aluminum with chemical film finish
Material Thickness—0.090"
- Tolerances: ± 0.06"

Customization

- Custom sizes—You may design a case from the standard sizes of deep drawn enclosures in the Deep Drawn Catalog.
- Panels, Brackets, Hardware to spec

Spot-welded, pre-drilled panel flange.
Includes a chemical film finished panel with basic case.
Threaded inserts installed to accept a full-sized panel.

CASE NUMBER	W	L	H ¹	H ²	T	ALLOY	R ¹	R ²	C	S	P	SIZE PANEL	WT LBS
608	7.00	8.00	2.50	6.00	0.06	1100-0	0.31	0.31	0.25	5.38	6.38	6.50 x 7.50	3.3
609	9.00	9.00	2.50	8.00	0.06	6061-0	0.50	0.50	0.25	7.38	7.38	8.50 x 8.50	4.7
610	6.69	10.69	2.50	6.00	.09	6061-0	0.50	0.50	0.22	5.00	9.00	6.19 x 10.19	4.8
611	7.00	11.00	2.50	6.00	0.06	6061-0	0.50	0.31	0.34	5.38	9.38	6.31 x 10.31	4.3
612	8.38	11.50	2.50	7.00	0.06	6061-0	0.50	0.56	0.25	6.75	9.87	7.88 x 11.00	4.9
613	9.19	13.25	2.50	9.00	0.09	6061-0	0.56	0.56	0.28	7.50	11.56	8.69 x 12.63	8.2
616	10.00	16.00	2.50	9.00	0.09	6061-0	1.00	1.00	0.28	8.31	14.31	9.50 x 15.50	9.8

Note: W, L and H are exterior dimensions, R¹, R², P and S are interior dimensions. T = Thickness. Measurements shown in inches.

PANEL DIMENSION GUIDE

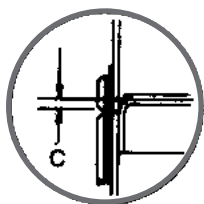
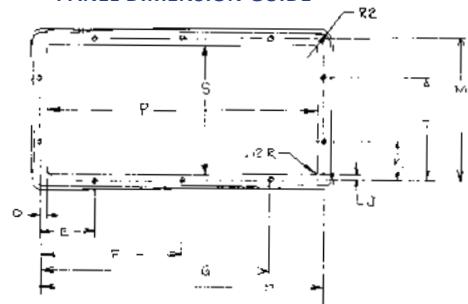

LATCH ASSEMBLY REFERENCE

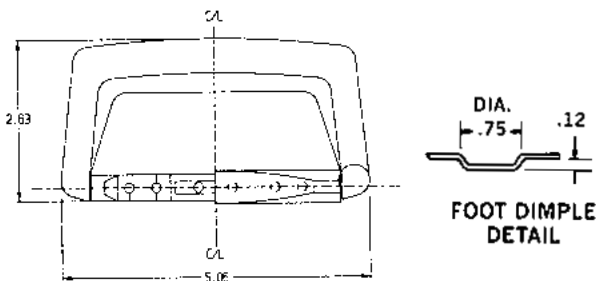
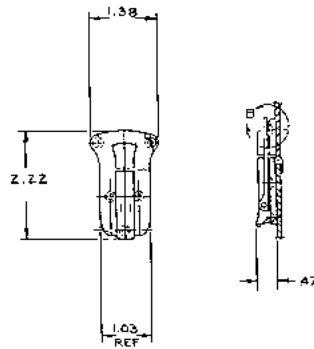

PANEL HOLE PATTERN DIMENSIONS

CASE	D	E	F	G	H	J	K	L	M
608	0.28	2.00	—	4.94	6.94	0.28	1.47	4.47	5.94
609	0.28	2.00	—	5.94	7.94	0.28	2.00	5.94	7.94
610	0.29	2.36	—	7.23	9.59	0.29	1.36	4.23	5.59
611	0.23	3.00	—	6.84	9.84	0.23	1.75	4.09	5.84
612	0.28	3.00	—	7.44	10.44	0.28	2.00	5.31	7.31
613	0.26	3.05	6.05	9.05	12.09	0.26	2.00	6.03	8.03
616	0.29	3.45	7.45	11.45	14.91	0.29	2.50	6.41	8.91



Off-Shelf Availability WITH No Tooling Charge

These distinctively designed deep drawn aluminum instrument cases give small instruments a sales-appealing custom appearance at off-the-shelf prices.

- Seamless deep drawn body provides protection even under rugged conditions.
- Aluminum front panel, recessed for protection of dials, meters, knobs, etc., is attached with four slotted screws for quick access.

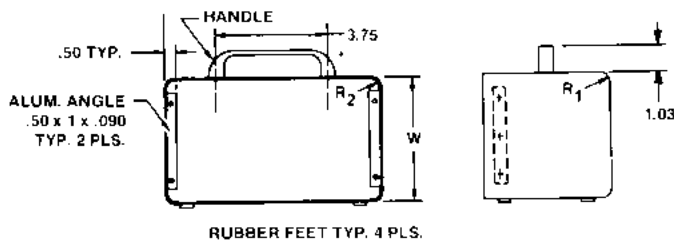

Specifications

- Material: 407 to 409: 1100-0, 0.063" Aluminum
411: 6061-0, 0.063" Aluminum
- Handle: Cast Aluminum, Brushed Finish
- Feet: Rubber
- Material: Aluminum Alloy.
- Latches: Zamak #7—nickel plated.
- Hinges: Riveted-nickel plated steel. Separable on all styles.
- Handle: Black molded plastic with nickel plated hardware.
- Feet: Integral dimpled
- Gasket: Black extruded synthetic rubber
- Panels: Aluminum with chemical film finish
- Material Thickness—0.090"
- Tolerances: ± 0.06"

Standard Finish

Textured Powder Coat Paint Finish
for Interior & Exterior, less hardware
MB Medium Blue Powder Coat, Color No. 25190
See Page 1 for custom color selections.

Hardware

- Handle: Gray injection molded acrylic based multi-polymers. Maximum carry weight 60 lbs.
- Seal: Elastomeric neoprene gasketed seal.
- Lock: Triple combination lock
- Hinge: 100X: Piano-type (continuous) aluminum with stainless steel pin riveted to case.
- Latches: Two positive locking draw-down type, chrome plated.

Accessories

- Panel: dimensions and drawing specifications—see table 2
- Brackets: See drawing, part number and installation instructions.
- Caster Kit: available only on case numbers 109X, 110X and 129X.
- Foam: Layered and Diced layered foam packs

Customization

- Custom sizes—You may design a case from the standard sizes of deep drawn enclosures in the Deep Drawn Catalog.
- Hardware to your specifications.

CASE NUMBERS AND DIMENSIONS

CASE NUMBER	W	L	DEPTH	R1	R2	WEIGHT
407	4.00	7.00	5.00	0.31	0.31	1.3
408	4.50	7.75	7.00	0.25	0.25	1.8
409	6.00	9.00	5.00	0.31	0.31	2.1
411	7.00	11.00	7.00	0.50	0.31	2.9

Note: measurements shown in inches. Weight shown in lbs.

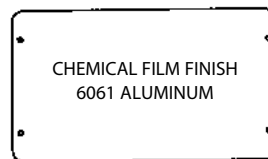
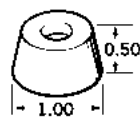

PANEL

